

Gruppo mandrino EB

ООО "СервоКИП"
603022, г.Нижний Новгород
ул. Тимирязева 15
(831) 433-04-81, 433-23-01, 421-43-89
e-mail: info@vem-it.ru www.vem-it.ru



Spindle units EB

Spindeln EB

Moteurs EB

Per calibratura, bisellatura, levigatura di marmo, granito, ceramica
- Albero forato per il passaggio dell'acqua
- Manicotto girevole per l'allacciamento idrico
- Movimentazione con cilindri
- Corsa albero mandrino: EB 13 = 50 mm, EB 16 = 80 mm
- Fermo meccanico
- Optional:
corsa albero mandrino: EB 13 = 70 mm, EB 16 = 100 mm
cilindri Ø 40 mm

Le caratteristiche e gli ingombri sono
indicativi e suscettibili di variazioni.
Verniciatura su richiesta.

For calibrating, bevelling, sanding applications in the marble, granite, ceramic industry
- Hollow shaft to allow water passage
- Revolving sleeve for rotary coolant union: included
- Spindle feed through cylinders
- Spindle stroke: EB 13 = 50 mm, EB 16 = 80 mm
- Stop device
- By request:
spindle stroke: EB 13 = 70 mm, EB 16 = 100 mm
cylinders Ø 40 mm

Features and overall dimensions are
subject to change.
Varnishing by request.

Zum Kalibrieren, Schleifen und Polieren von Marmor, Granit und Keramik
- Gebohrte Welle für den Wasserdurchgang
- Mit Drehmuffe für den Wasseranschluss
- Spindelhub: EB 13 = 50 Mm, EB 16 = 80 Mm
- Mechanische Klemmvorrichtung
- Auf Anfrage:
Spindelhub: EB 13 = 70 Mm, EB 16 = 100 Mm
Zylinder Ø 40 Mm

Technische Eigenschaften und Abmaße
sind änderungsfähig.
Lackierung auf Anfrage.

Pour calibrage, polissage, ponçage de marbre, granit, céramique
- Arbre creux pour le passage de l'eau
- Raccord rotatif pour arrivée d'eau
- Avance manuelle du coulisseau par système visécrou centrale
- Course du coulisseau: EB 13 = 50 mm, EB 16 = 80 mm
- Butée mécanique
- En option:
course du coulisseau: EB 13 = 70 mm, EB 16 = 100 mm
cylindre Ø 40 mm

Sous réserve, modifications techniques
et de construction.
Peinture en option.

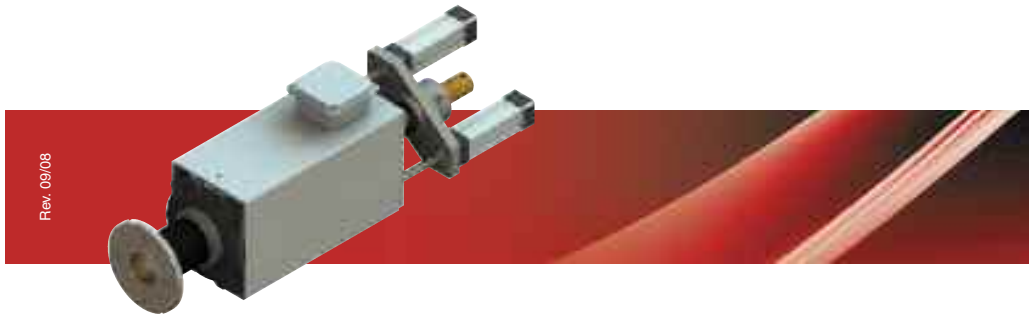

Rev. 09/08

Ingombri | overall dimensions | abmaße | encombrements

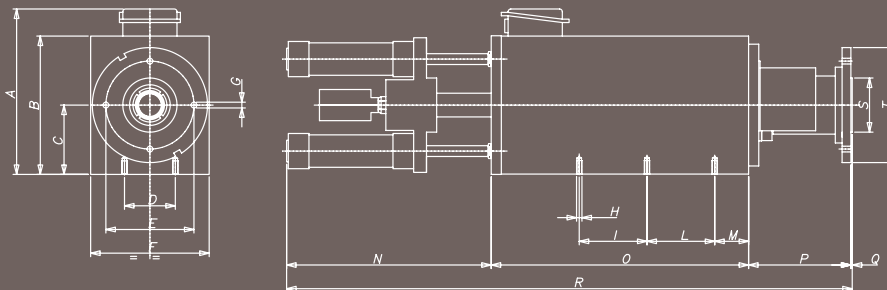

Tipo	A	B	C	D	E	F	G	H	I	L	M	N	O	P	Q	R	S	T
EB 13	235	174,5	87,5	75	116,5	145	M8 3 fori	M8x20 6 fori	100	100	50	218 (168)	302 (163)	113	2	635	80	130
EB 16	265	204,5	102,5	75	130	175	8,5 4 fori	M8x20 6 fori	100	100	50	310 (230)	380 (235)	155	2	847	80	170

Caratteristiche elettriche | electrical data | elektrische daten | caractéristiques électriques

Tipo	servizio S1				RPM	Kg
	Cv	kW	Poli	Amp. V.380		
EB 13 A	3,2	2,3	2	5,6	2800	29,5
EB 13 E	4	3	2	6,6	2840	30
EB 13 B	2	1,5	4	4	1420	29,5
EB 13 C	1,5	1,1	6	3,2	900	29,5
EB 13 D	2/2,5	1,5/1,8	4/2	4,2/4,5	1410/2820	29,5
EB 16 A	6,5	4,8	2	10,8	2810	61
EB 16 B	5	3,7	4	8,7	1410	61
EB 16 C	3,5	2,6	6	6,6	920	61
EB 16 D	4/5	3/3,7	4/2	7,8/9,4	1410/2830	61